

KEY TO ELECTRICAL LAYOUT

	SINGLE POLE ONE WAY SWITCH
	SINGLE POLE TWO WAY SWITCH
	3 PINS 16 AMPS PLUG
	3 PINS 6 AMPS PLUG
	20A AC Switch
	20A 3 Pin AC Socket
	FAN REGULATOR
	CEILING LIGHT (SURFACE MOUNTED)
	MIRROR LIGHT
	TELEPHONE / INTERCOM
	ANTENNA
	DISTRIBUTION BOARD
	CALLING SWITCH
	CALLING BELL
	WALL BRACKET
	CEILING FAN
	EXHAUST FAN
	FOOT LAMB
	HEATER SWITCH
	20A DP MCB CHANGE OVER (Inverter)
	BULK HEAD

NOTE

- * ALL SWITCH BOARDS ARE 3'0" FROM FFL. BOTTOM OF SWITCH
- * BED SIDE 6 AMPS PLUGS ARE AT 2'0" FROM FFL.
- * ALL WALL BRACKETS 7'0" HIGH FROM FFL.
- * FOOT LIGHT IN BEDROOM TO BE PROVIDED AT 12" FROM F.F.L. (IN LINE WITH BEDROOM SWITCH BOX)

SCHEDULE OF JOINERY			
TYPE	DESCRIPTION	SIZE (IN METER)	SILL
MD	DOOR	1.066 x 2.135	-
D	DOOR	0.915 x 2.135	-
D1	DOOR	0.840 x 2.135	-
D2	DOOR	0.762 x 2.135	-
W	SLIDING WINDOW	2.055 x 1.370	0.765
W1	SLIDING WINDOW	1.420 x 1.070	1.065
W2	SLIDING WINDOW ABOVE FIXED GLASS	1.225 x 1.370	0.765
	BOTTOM OF BEAM	0.535	
V	VENTILATOR	0.600 x 0.915	1.220
FG	FIXED GLAZING	0.750 x 1.370	0.905
FG2	FIXED GLAZING	0.675 x 1.325	1.385

TYPICAL FLOOR PLAN -(TYPE-K)

VILLA No.- 86 (EAST FACING)

REV. NO:R1 DATE: 28.02.19

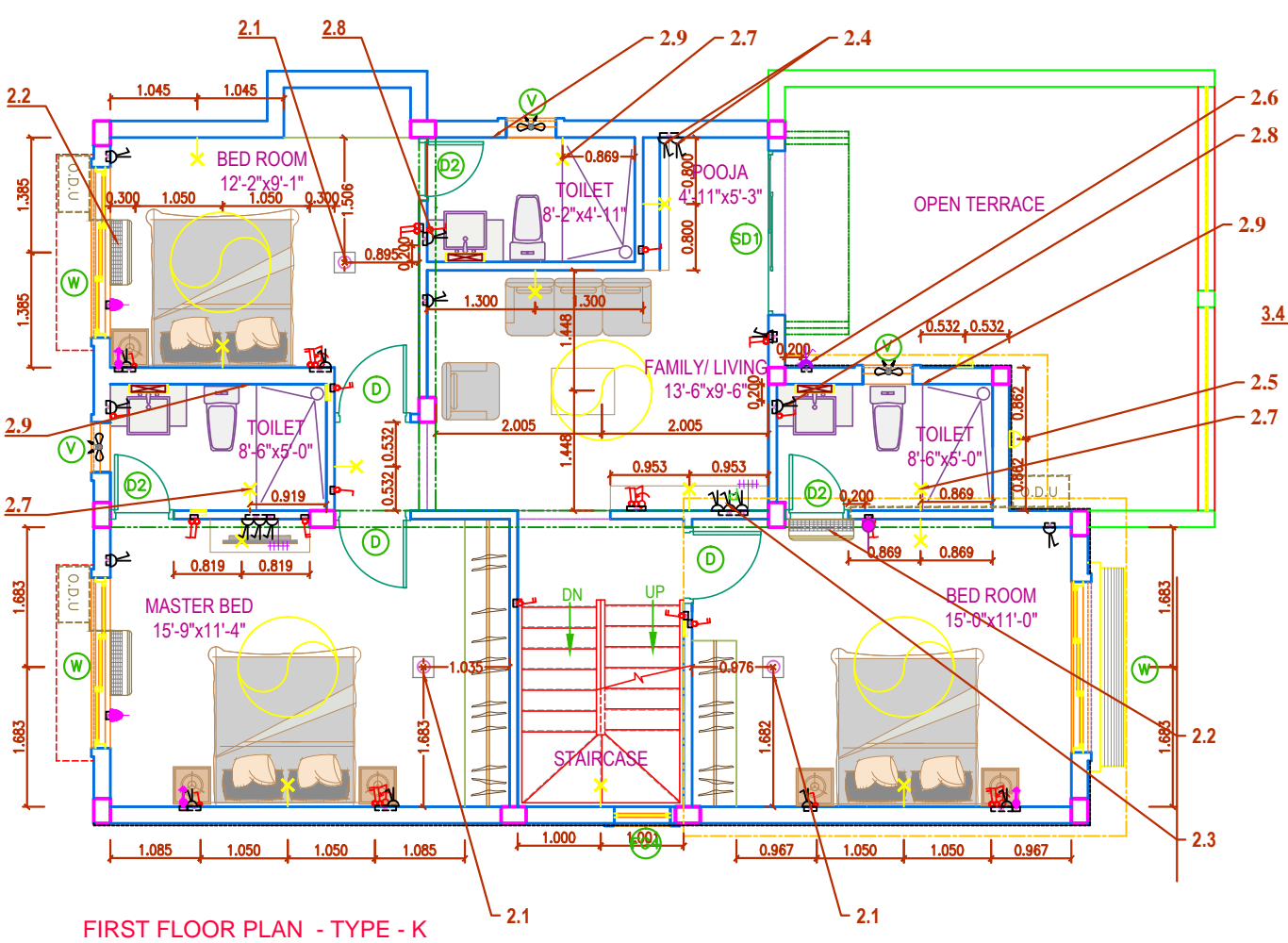

FIRST FLOOR PLAN - TYPE - K

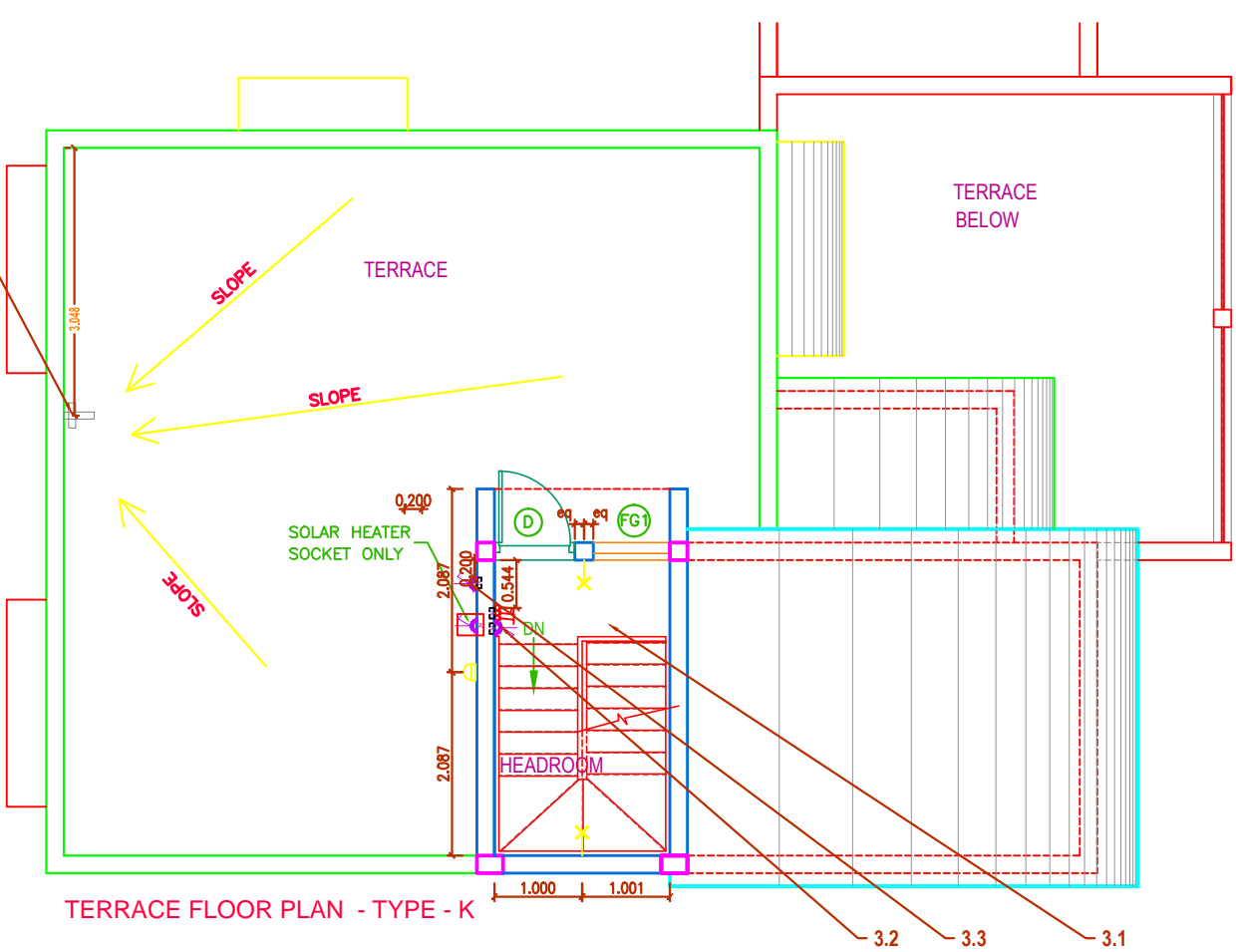

TERRACE FLOOR PLAN - TYPE - K

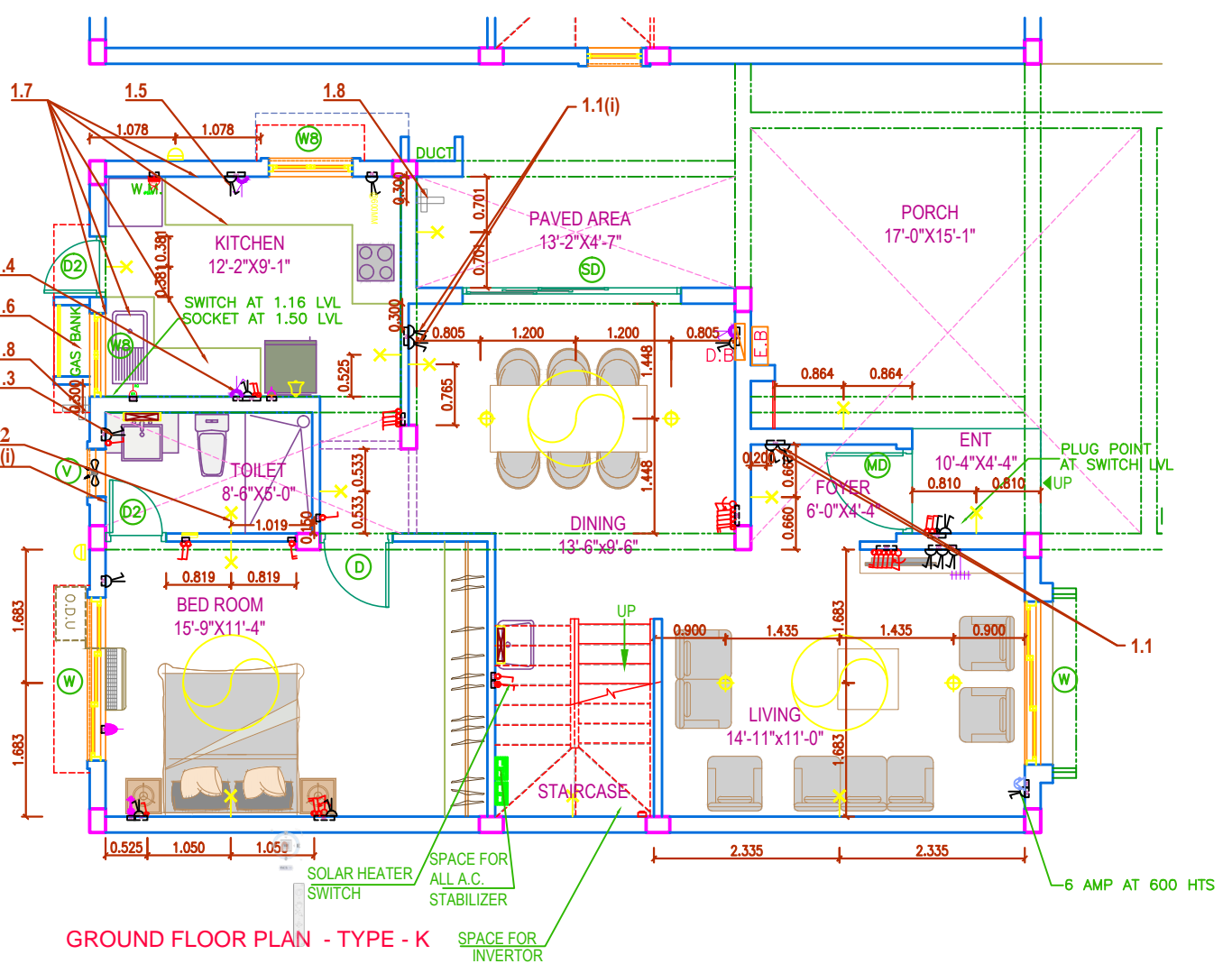

GROUND FLOOR PLAN - TYPE - K